

LAND SALE NOTICE

CANDLER 56 TRACT 56.0+/- ACRES CANDLER COUNTY, GA OFFERED AT \$64,400 (\$1,150/AC.)

The Candler 56 tract is located less than 10 miles from Metter, GA and is the ideal property for an affordable homesite, timberland investment, or those looking for a place to enjoy outdoor activities.

The property has been recently harvested of all pine timber. The upland areas can be easily reforested for pine timber production, converted to pasture, or converted to orchard. The western boundary is a creek and remains in mature hardwoods. There is a 1.7+/- acre pond centrally located on the property. Any Buyer must agree to continue the CUA property tax agreement.

Convenient access to Interstate 16 and Savannah, GA.

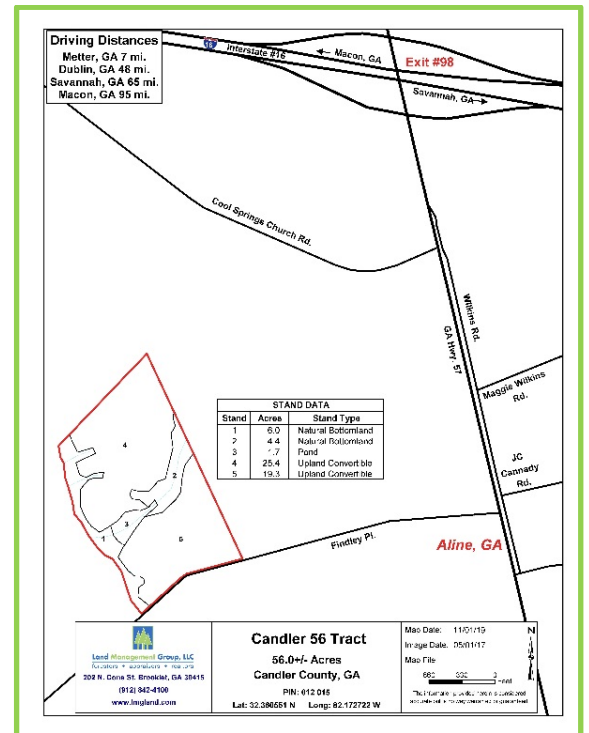

Land Management Group, LLC

foresters • appraisers • realtors

Contact: F. Scott Brookins (912) 682-0268 | scott@lmgland.com

We specialize in the sale of timberland and recreational properties